

MOSA valve conn. form C 9,4mm field-wireable (IDC)

Form CI (9.4 mm), insulation displacement technology

0...250 V AC/300 V DC, without components

Cable outlet can be turned in 90° steps

Image

Vicarious picture

Approvals**Form**

94101

Technical Data

Operating voltage	0...250 V AC/300 V DC
Operating current per contact (40 °C)	max. 3 A
Connection diameter	0.25...0.5 mm ² (conductor diameter \geq 0.1 mm)
Outer wire diameter	1.2...1.6 mm
Clamping range (cable diameter)	4...6 mm
Protection	IP65 and IP67 when plugged and screwed down (EN 60529)
Temperature range	-25...+85 °C
Dimensions H x W x D	28 x 16 x 16 / M14 x 1 mm
Total length	Installation: 44.5 mm

Commercial data

Net weight	17
Net weight	17
Weight unit	gram
Basic unit	pc.
Customs tariff number	85369010
Unit (piece)	1
Limited value	1

Comments

Plastic housings with good resistance against chemicals and oils.
The resistance to aggressive media should be individually tested for your application. Further details on request.

All data on this data sheet was compiled carefully.

Liability regarding correctness, completeness, and actuality is limited to gross negligence. Created: 06/12

Contact layout

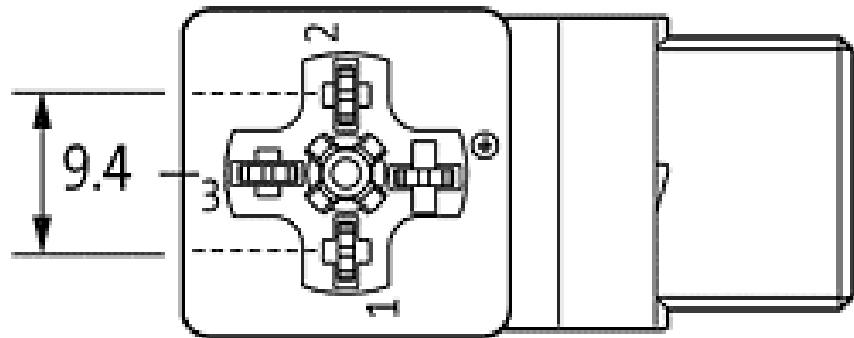

Circuit diagram

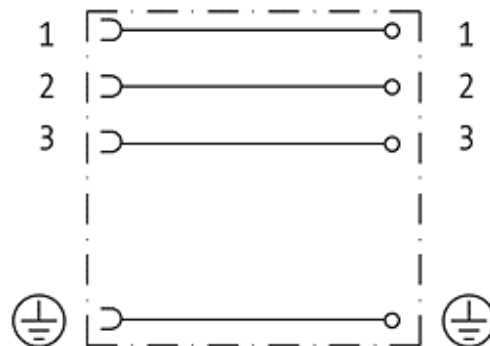

Representante oficial de:



[Argentina – Uruguay – Paraguay – Bolivia – Colombia – y Perú.]



Calle 49 N° 5764 - Villa Ballester (B1653AOX) - Prov. de Buenos Aires - ARGENTINA
Tel: (+54 11) 4768-4242 / Fax: (+54 11) 4849-1212
Mail: ventas@nakase.com.ar / Web: www.nakase.com.ar

